

STAGE 1







PROJECT
THE PARKS
 TITLE
CENTRAL PARK RELEASE - STAGE 1
INFRASTRUCTURE MASTER SERVICES
 DATE 15.04.26 SCALE AS SHOWN PROJ. No. TPN25-005 REV. P2



DISCLAIMER

THESE PLANS AND DRAWINGS ARE FOR CONCEPTUAL AND ILLUSTRATIVE PURPOSES ONLY. ALL DIMENSIONS, EASEMENTS, LEVELS AND SPECIFICATIONS ARE APPROXIMATE AND SUBJECT TO MODIFICATION, SUBSTITUTION, OR CHANGE WITHOUT PRIOR NOTICE.
 NO RELIANCE SHOULD BE PLACED ON THESE PLANS FOR FINAL DECISIONS REGARDING PURCHASING, DESIGN, OR CONSTRUCTION. HOLTZE LAND COMPANY PTY LTD DISCLAIMS ALL LIABILITY FOR ANY ERRORS, OMISSIONS, OR INACCURACIES CONTAINED HEREIN AND ACCEPTS NO LIABILITY FOR LOSS SUFFERED BY ANY PERSON WHO RELIES ON THIS PLAN.

LEGEND

-  STORMWATER DRAINAGE
-  WATER RETICULATION
-  SEWERAGE
-  ELECTRICAL
-  ELECTRICAL PILLAR & COMMS LEAD IN CONDUIT
-  3.5m WIDE NOM. DRIVEWAY

DATE: 15/04/2026 4:33:29 AM LOGIN NAME: TROYB LOCATION: c:\Users\troyb\OneDrive - TPN\ENGIN\TPN - Projects\TPN25-005 The Parks\30 Delivery\02 Drawings\01 Stage 1\W317000-JAC-DD-01-SKT-CI-000030.dwg

DATE: 15/04/2026 4:33:31 AM LOGIN NAME: TROYB
 LOCATION: c:\Users\troyb\OneDrive - TPN ENGIN\TPN ENGIN - Projects\TPN25-005 The Parks\30 Delivery\02 Drawings\01 Stage 1\W317000-JAC-DD-01-SKT-CI-000030.dwg

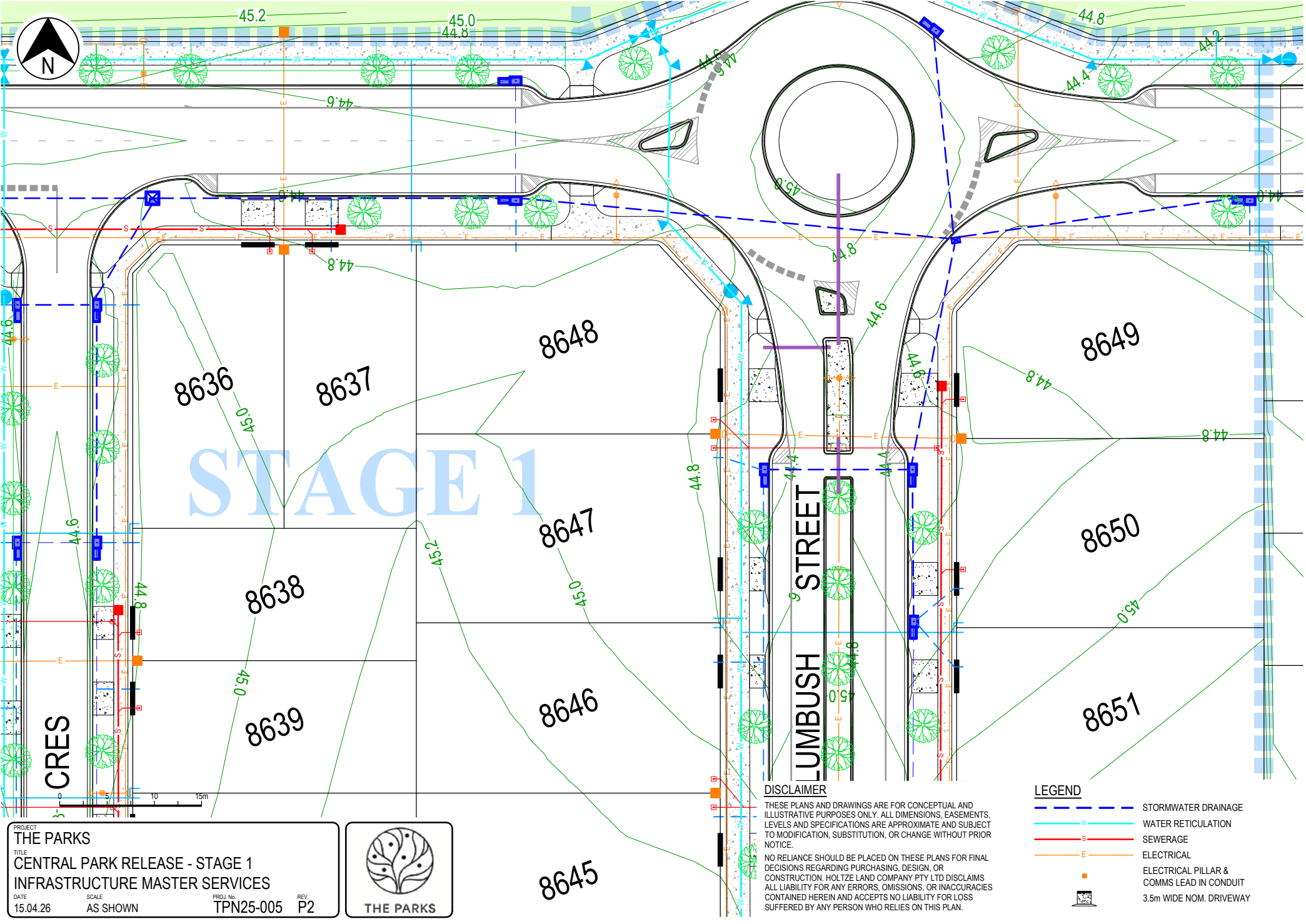

PROJECT
THE PARKS
 TITLE
CENTRAL PARK RELEASE - STAGE 1
INFRASTRUCTURE MASTER SERVICES
 DATE: 15.04.26 SCALE: AS SHOWN PROJ. No: TPN25-005 REV. P2



DISCLAIMER

THESE PLANS AND DRAWINGS ARE FOR CONCEPTUAL AND ILLUSTRATIVE PURPOSES ONLY. ALL DIMENSIONS, EASEMENTS, LEVELS AND SPECIFICATIONS ARE APPROXIMATE AND SUBJECT TO MODIFICATION, SUBSTITUTION, OR CHANGE WITHOUT PRIOR NOTICE.

NO RELIANCE SHOULD BE PLACED ON THESE PLANS FOR FINAL DECISIONS REGARDING PURCHASING, DESIGN, OR CONSTRUCTION. HOLTZE LAND COMPANY PTY LTD DISCLAIMS ALL LIABILITY FOR ANY ERRORS, OMISSIONS, OR INACCURACIES CONTAINED HEREIN AND ACCEPTS NO LIABILITY FOR LOSS SUFFERED BY ANY PERSON WHO RELIES ON THIS PLAN.

LEGEND

- STORMWATER DRAINAGE
- WATER RETICULATION
- SEWERAGE
- ELECTRICAL
- ELECTRICAL PILLAR & COMMS LEAD IN CONDUIT
- 3.5m WIDE NOM. DRIVEWAY

DATE: 15/04/2026 4:33:33 AM LOGIN NAME: TROYB
 LOCATION: c:\Users\roy@OneDrive - TPN\ENGIN\TPN - Projects\TPN25-005 The Parks\30 Delivery\02 Drawings\01 Stage 1\W317000-JAC-DD-01-SKT-CI-000030.dwg

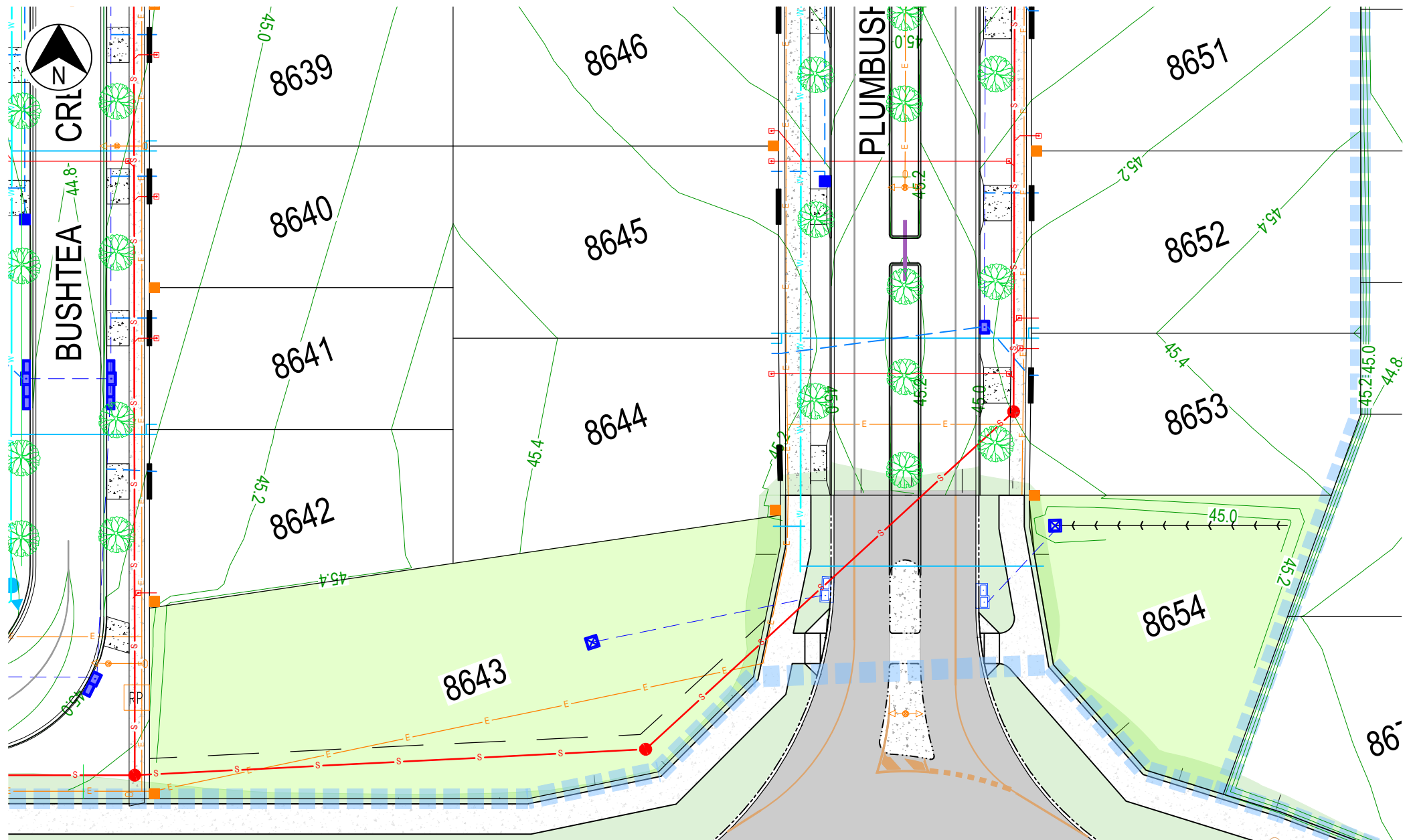

PROJECT
THE PARKS
 TITLE
CENTRAL PARK RELEASE - STAGE 1
INFRASTRUCTURE MASTER SERVICES
 DATE: 15.04.26 SCALE: AS SHOWN PROJ. No: TPN25-005 REV. P2



DISCLAIMER
 THESE PLANS AND DRAWINGS ARE FOR CONCEPTUAL AND ILLUSTRATIVE PURPOSES ONLY. ALL DIMENSIONS, EASEMENTS, LEVELS AND SPECIFICATIONS ARE APPROXIMATE AND SUBJECT TO MODIFICATION, SUBSTITUTION, OR CHANGE WITHOUT PRIOR NOTICE.
 NO RELIANCE SHOULD BE PLACED ON THESE PLANS FOR FINAL DECISIONS REGARDING PURCHASING, DESIGN, OR CONSTRUCTION. HOLTZE LAND COMPANY PTY LTD DISCLAIMS ALL LIABILITY FOR ANY ERRORS, OMISSIONS, OR INACCURACIES CONTAINED HEREIN AND ACCEPTS NO LIABILITY FOR LOSS SUFFERED BY ANY PERSON WHO RELIES ON THIS PLAN.

LEGEND

- STORMWATER DRAINAGE
- WATER RETICULATION
- SEWERAGE
- ELECTRICAL
- ELECTRICAL PILLAR & COMMS LEAD IN CONDUIT
- 3.5m WIDE NOM. DRIVEWAY



GREENANT ROAD

BUSHTEA CRES

CRES

STA

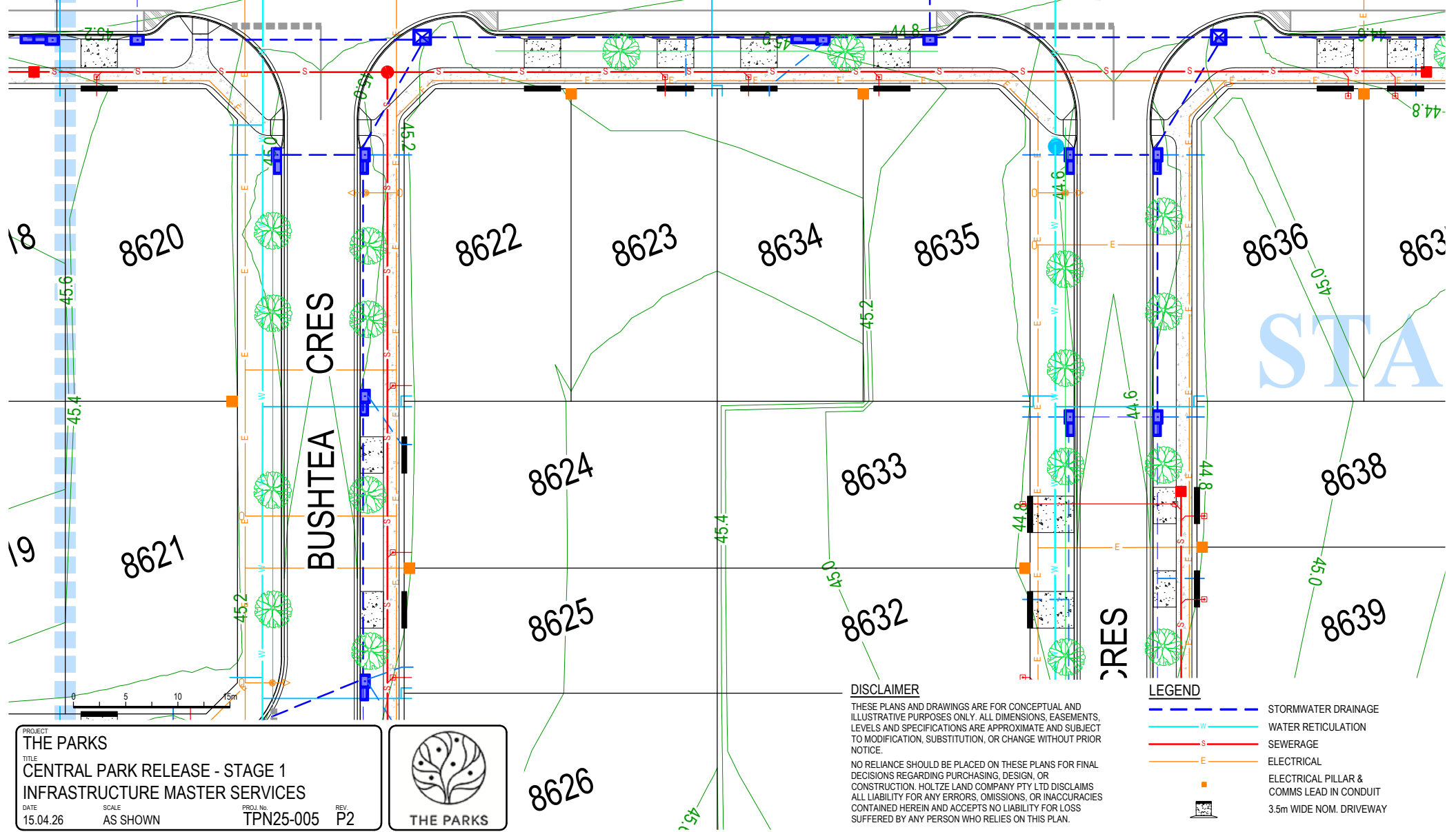







DISCLAIMER

THESE PLANS AND DRAWINGS ARE FOR CONCEPTUAL AND ILLUSTRATIVE PURPOSES ONLY. ALL DIMENSIONS, EASEMENTS, LEVELS AND SPECIFICATIONS ARE APPROXIMATE AND SUBJECT TO MODIFICATION, SUBSTITUTION, OR CHANGE WITHOUT PRIOR NOTICE.

NO RELIANCE SHOULD BE PLACED ON THESE PLANS FOR FINAL DECISIONS REGARDING PURCHASING, DESIGN, OR CONSTRUCTION. HOLTZE LAND COMPANY PTY LTD DISCLAIMS ALL LIABILITY FOR ANY ERRORS, OMISSIONS, OR INACCURACIES CONTAINED HEREIN AND ACCEPTS NO LIABILITY FOR LOSS SUFFERED BY ANY PERSON WHO RELIES ON THIS PLAN.

LEGEND

-  STORMWATER DRAINAGE
-  WATER RETICULATION
-  SEWERAGE
-  ELECTRICAL
-  ELECTRICAL PILLAR & COMMS LEAD IN CONDUIT
-  3.5m WIDE NOM. DRIVEWAY

PROJECT
THE PARKS

TITLE
**CENTRAL PARK RELEASE - STAGE 1
INFRASTRUCTURE MASTER SERVICES**

DATE 15.04.26 SCALE AS SHOWN PROJ. No. TPN25-005 REV. P2



DATE: 15/04/2026 4:33:34 AM LOGIN NAME: TROYB LOCATION: c:\Users\royb\OneDrive - TPN\ENGIN\TPN - Projects\TPN25-005 The Parks\30 Delivery\02 Drawings\01 Stage 1\W317000-JAC-DD-01-SKT-CI-000030.dwg

DATE: 15/04/2026 5:54:54 AM LOGIN NAME: TROYB
 LOCATION: c:\Users\troyb\OneDrive - TPN ENGINTECH ENG - Projects\TPN25-005 The Parks\30 Delivery\02 Drawings\01 Stage 1\W317000-JAC-DD-01-SKT-CI-000030.dwg

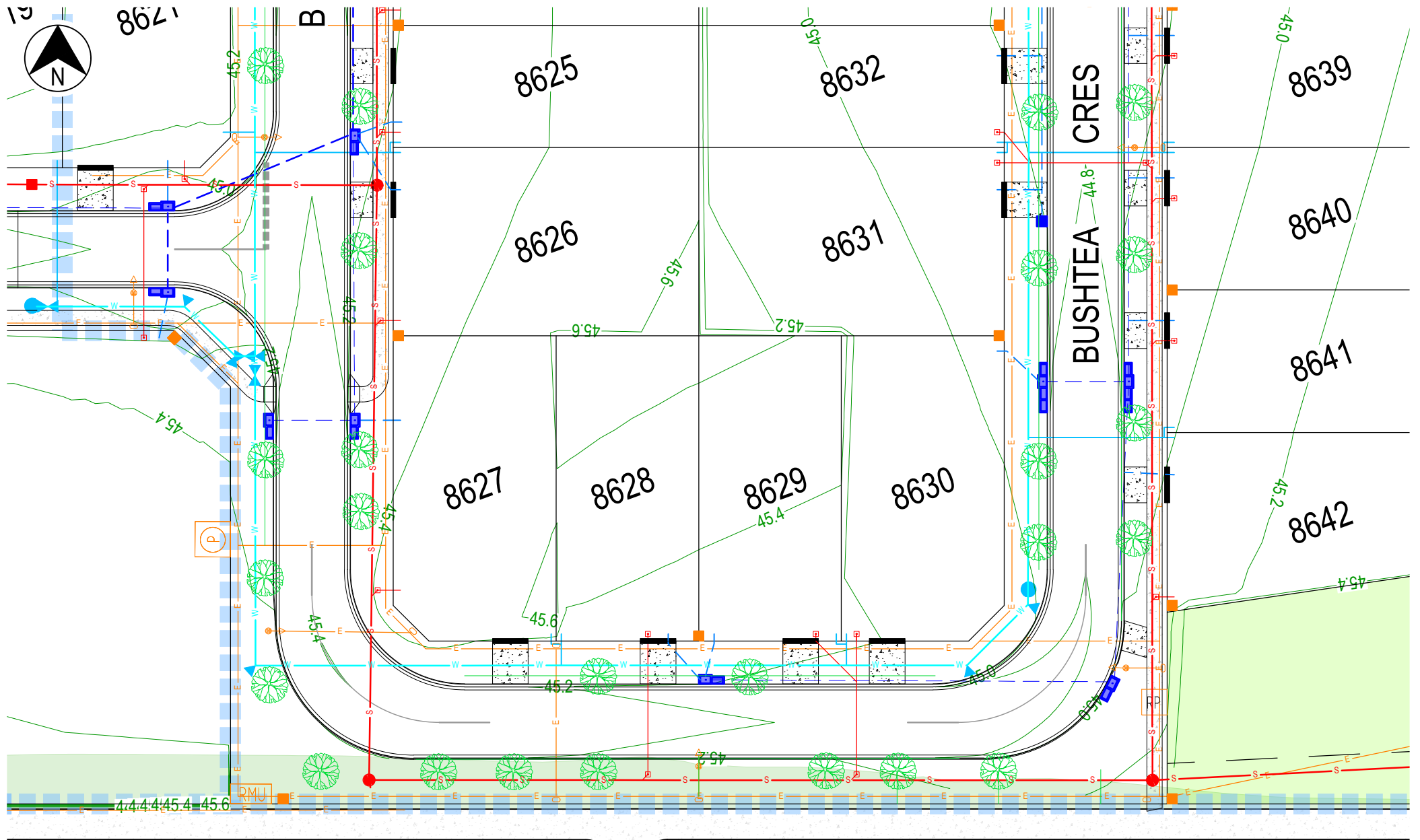

PROJECT
THE PARKS
 TITLE
CENTRAL PARK RELEASE - STAGE 1
INFRASTRUCTURE MASTER SERVICES
 DATE 15.04.26 SCALE AS SHOWN PROJ. No. TPN25-005 REV. P2



DISCLAIMER

THESE PLANS AND DRAWINGS ARE FOR CONCEPTUAL AND ILLUSTRATIVE PURPOSES ONLY. ALL DIMENSIONS, EASEMENTS, LEVELS AND SPECIFICATIONS ARE APPROXIMATE AND SUBJECT TO MODIFICATION, SUBSTITUTION, OR CHANGE WITHOUT PRIOR NOTICE.
 NO RELIANCE SHOULD BE PLACED ON THESE PLANS FOR FINAL DECISIONS REGARDING PURCHASING, DESIGN, OR CONSTRUCTION. HOLTZE LAND COMPANY PTY LTD DISCLAIMS ALL LIABILITY FOR ANY ERRORS, OMISSIONS, OR INACCURACIES CONTAINED HEREIN AND ACCEPTS NO LIABILITY FOR LOSS SUFFERED BY ANY PERSON WHO RELIES ON THIS PLAN.

LEGEND

- STORMWATER DRAINAGE
- WATER RETICULATION
- SEWERAGE
- ELECTRICAL
- ELECTRICAL PILLAR & COMMS LEAD IN CONDUIT
- 3.5m WIDE NOM. DRIVEWAY