

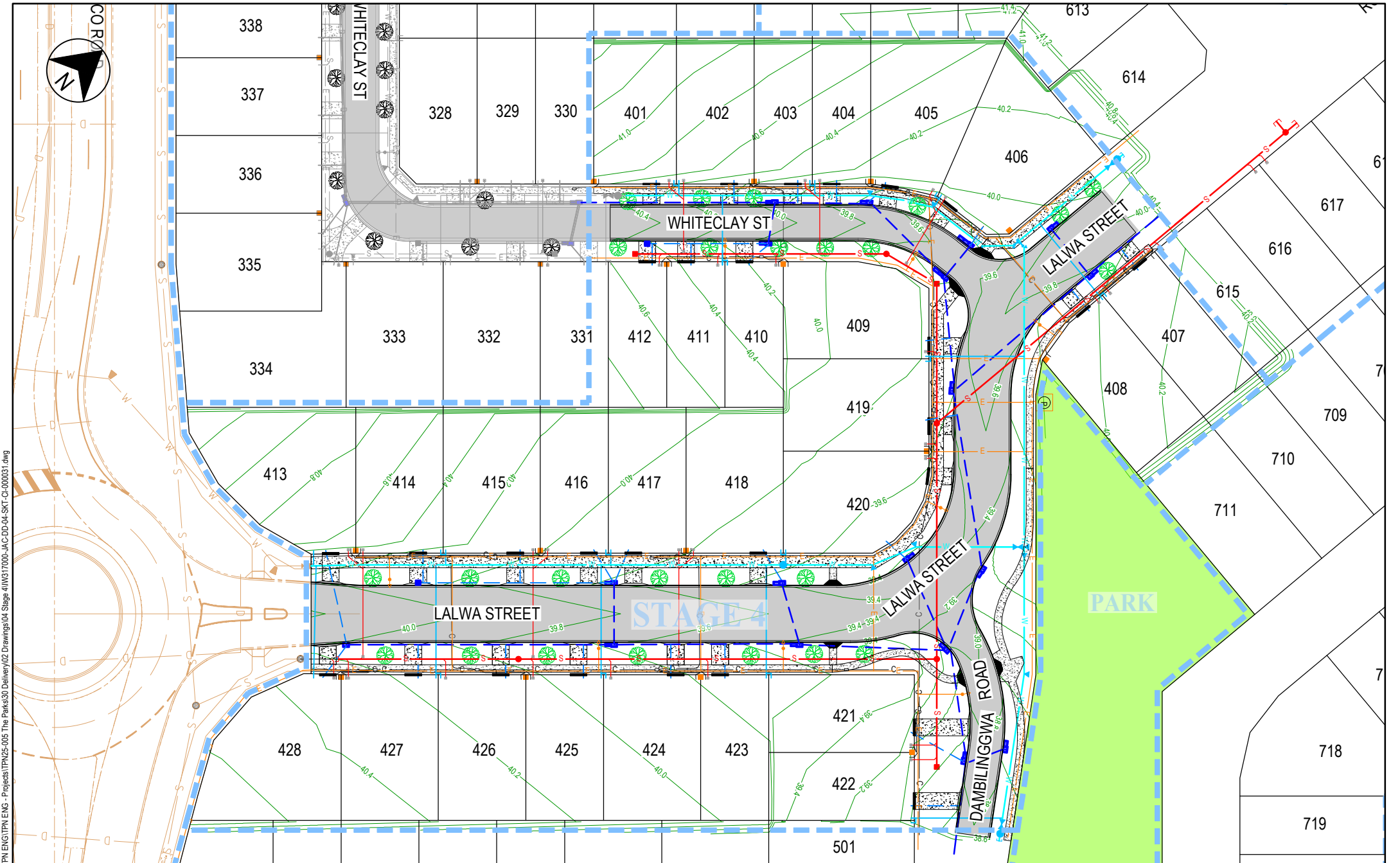

DATE: 15/04/2026 2:28:21 PM LOGIN NAME: TROYB LOCATION: C:\Users\TroyB\OneDrive - TPN ENGIN\TPN - Projects\TPN25-005 The Parks\30 Delivery\02 Drawings\04 Stage 4\HW317000-JAC-DD-04-SKT-CI-000031.dwg



PROJECT
THE PARKS - STAGE 4

TITLE
SAMARIA PARK RELEASE

INFRASTRUCTURE MASTER SERVICES

DATE: 15.04.26 SCALE: AS SHOWN PROJ. No: TPN25-005 REV. P6



DISCLAIMER

THESE PLANS AND DRAWINGS ARE FOR CONCEPTUAL AND ILLUSTRATIVE PURPOSES ONLY. ALL DIMENSIONS, EASEMENTS, LEVELS AND SPECIFICATIONS ARE APPROXIMATE AND SUBJECT TO MODIFICATION, SUBSTITUTION, OR CHANGE WITHOUT PRIOR NOTICE.

NO RELIANCE SHOULD BE PLACED ON THESE PLANS FOR FINAL DECISIONS REGARDING PURCHASING, DESIGN, OR CONSTRUCTION. HOLTZE LAND COMPANY PTY LTD DISCLAIMS ALL LIABILITY FOR ANY ERRORS, OMISSIONS, OR INACCURACIES CONTAINED HEREIN AND ACCEPTS NO LIABILITY FOR LOSS SUFFERED BY ANY PERSON WHO RELIES ON THIS PLAN.

LEGEND

	STORMWATER DRAINAGE
	WATER RETICULATION
	SEWERAGE
	ELECTRICAL



ELECTRICAL PILLAR & COMMS LEAD IN CONDUIT
3.5m WIDE NOM. DRIVEWAY

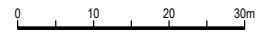



LEGEND	
	STORMWATER DRAINAGE
	WATER RETICULATION
	SEWERAGE
	ELECTRICAL
	ELECTRICAL PILLAR & COMMS LEAD IN CONDUIT
	3.5m WIDE NOM. DRIVEWAY

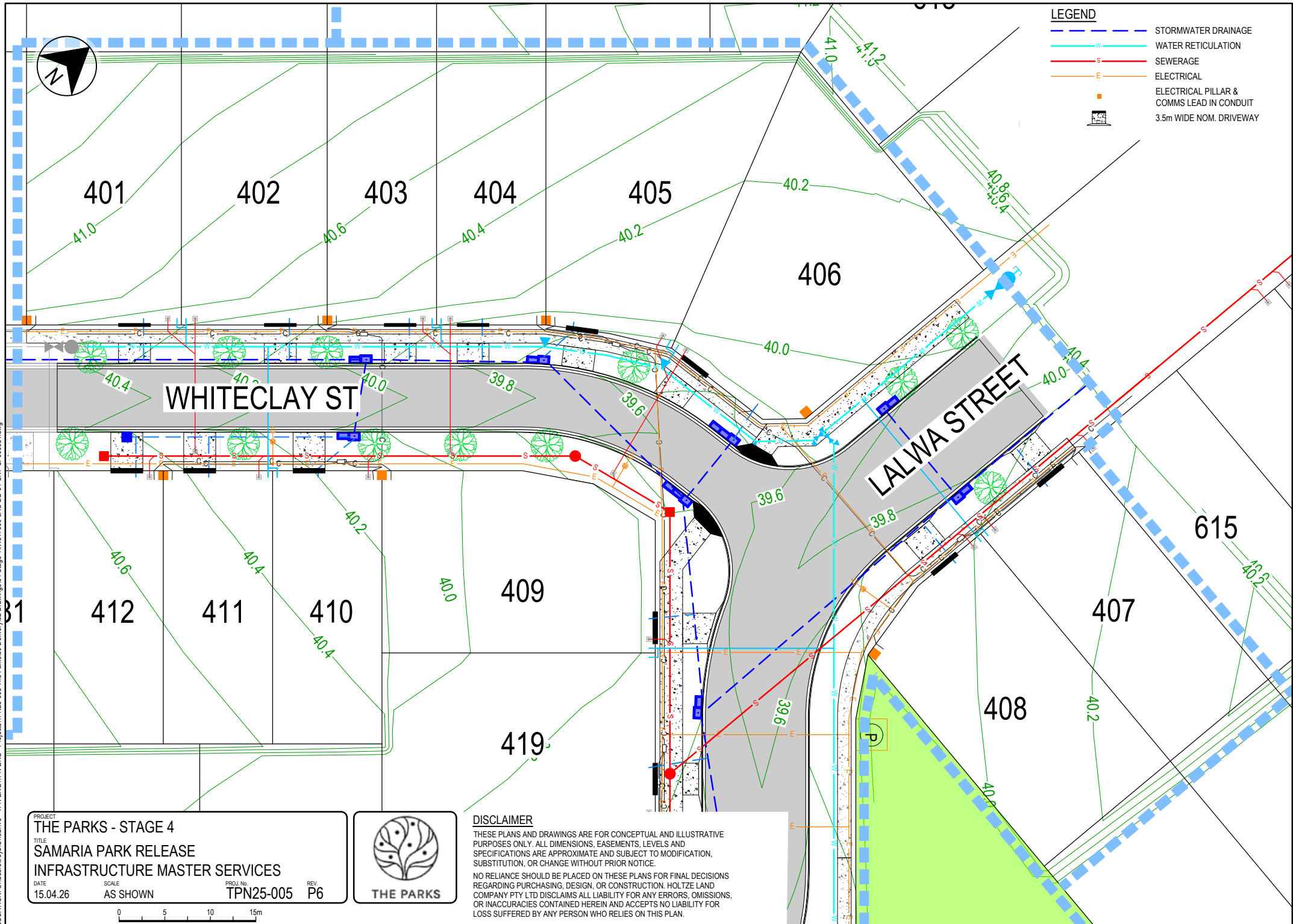

DATE: 15/04/2026 2:28:48 PM LOGIN NAME: TROYB
 LOCATION: c:\Users\troyb\OneDrive - TPN ENGIN\TPN - Projects\TPN25-005 The Parks\30 Delivery\02 Drawings\04 Stage 4\HW317000-JAC-DD-04-SKT-CI-000031.dwg

PROJECT			
THE PARKS - STAGE 4			
TITLE			
SAMARIA PARK RELEASE			
INFRASTRUCTURE MASTER SERVICES			
DATE	SCALE	PROJ. No.	REV.
15.04.26	AS SHOWN	TPN25-005	P6



DISCLAIMER

THESE PLANS AND DRAWINGS ARE FOR CONCEPTUAL AND ILLUSTRATIVE PURPOSES ONLY. ALL DIMENSIONS, EASEMENTS, LEVELS AND SPECIFICATIONS ARE APPROXIMATE AND SUBJECT TO MODIFICATION, SUBSTITUTION, OR CHANGE WITHOUT PRIOR NOTICE.

NO RELIANCE SHOULD BE PLACED ON THESE PLANS FOR FINAL DECISIONS REGARDING PURCHASING, DESIGN, OR CONSTRUCTION. HOLTZE LAND COMPANY PTY LTD DISCLAIMS ALL LIABILITY FOR ANY ERRORS, OMISSIONS, OR INACCURACIES CONTAINED HEREIN AND ACCEPTS NO LIABILITY FOR LOSS SUFFERED BY ANY PERSON WHO RELIES ON THIS PLAN.





- LEGEND**
- STORMWATER DRAINAGE
 - WATER RETICULATION
 - SEWERAGE
 - ELECTRICAL
 - ELECTRICAL PILLAR & COMMS LEAD IN CONDUIT
 - 3.5m WIDE NOM. DRIVEWAY

413 414 415 416 417 418

LALWA STREET

STAGE 4

428 427 426 425 424 423

PROJECT
THE PARKS - STAGE 4

TITLE
**SAMARIA PARK RELEASE
INFRASTRUCTURE MASTER SERVICES**

DATE 15.04.26 SCALE AS SHOWN PROJ. No. TPN25-005 REV. P6





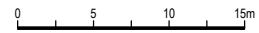



DISCLAIMER
THESE PLANS AND DRAWINGS ARE FOR CONCEPTUAL AND ILLUSTRATIVE PURPOSES ONLY. ALL DIMENSIONS, EASEMENTS, LEVELS AND SPECIFICATIONS ARE APPROXIMATE AND SUBJECT TO MODIFICATION, SUBSTITUTION, OR CHANGE WITHOUT PRIOR NOTICE.
NO RELIANCE SHOULD BE PLACED ON THESE PLANS FOR FINAL DECISIONS REGARDING PURCHASING, DESIGN, OR CONSTRUCTION. HOLTZE LAND COMPANY PTY LTD DISCLAIMS ALL LIABILITY FOR ANY ERRORS, OMISSIONS, OR INACCURACIES CONTAINED HEREIN AND ACCEPTS NO LIABILITY FOR LOSS SUFFERED BY ANY PERSON WHO RELIES ON THIS PLAN.



DATE: 15/04/2026 2:29:21 PM LOGIN NAME: TROYB LOCATION: c:\Users\troyb\OneDrive - TPN ENGINTECH ENG - Projects\TPN25-005 The Parks\30 Delivery\02 Drawings\04 Stage 4\HW317000-JAC-DD-04-SKT-CI-000031.dwg



LEGEND

-  STORMWATER DRAINAGE
-  WATER RETICULATION
-  SEWERAGE
-  ELECTRICAL
-  ELECTRICAL PILLAR & COMMS LEAD IN CONDUIT
-  3.5m WIDE NOM. DRIVEWAY

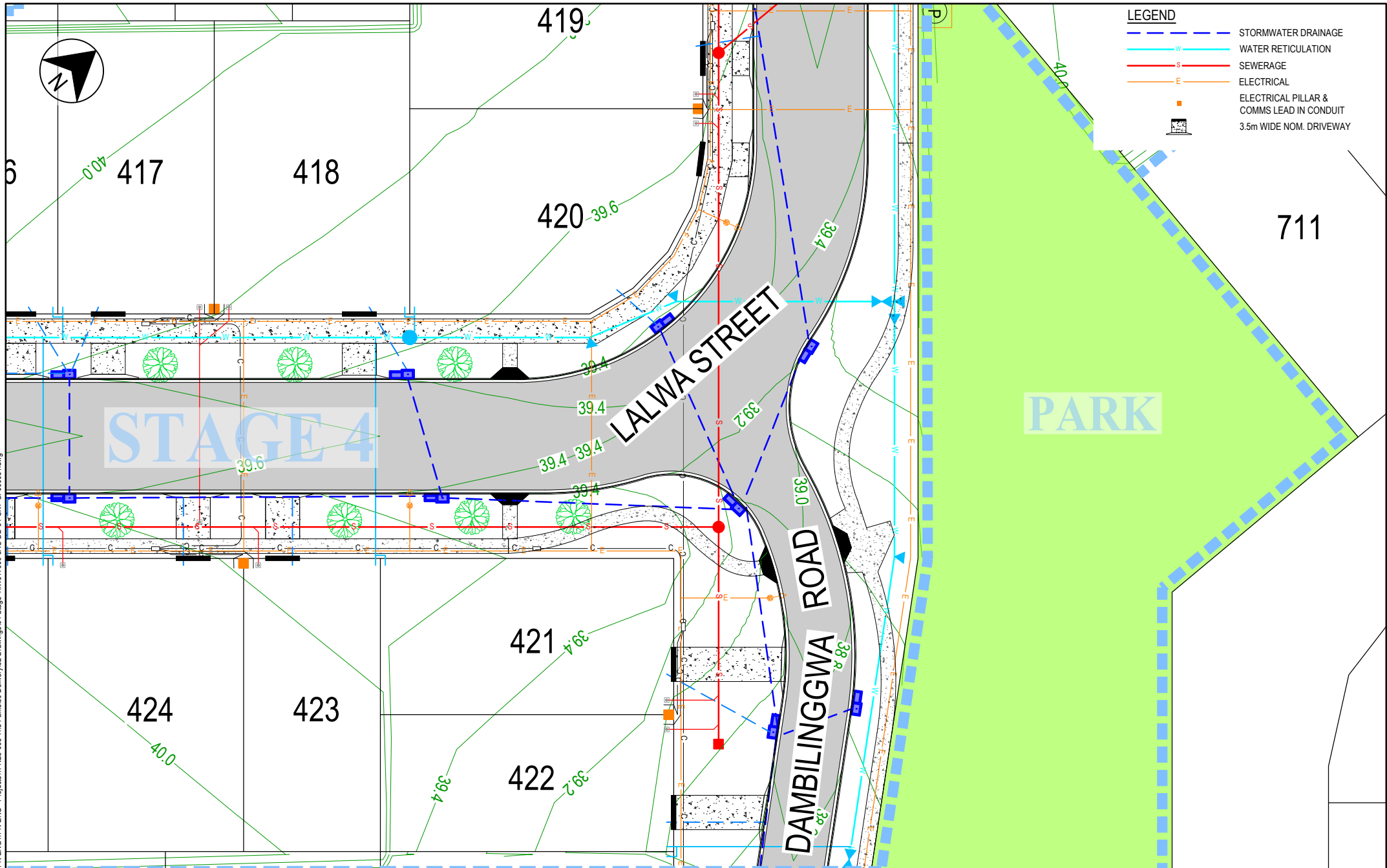

DATE: 15/04/2026 2:29:51 PM LOGIN NAME: TROYB
 LOCATION: c:\Users\TroyB\OneDrive - TPN\ENGIN\TPN - Projects\TPN25-005 The Parks\30 Delivery\02 Drawings\04 Stage 4\IW317000-JAC-DD-04-SKT-CI-000031.dwg

PROJECT			
THE PARKS - STAGE 4			
TITLE			
SAMARIA PARK RELEASE			
INFRASTRUCTURE MASTER SERVICES			
DATE	SCALE	PROJ. No.	REV.
15.04.26	AS SHOWN	TPN25-005	P6



DISCLAIMER

THESE PLANS AND DRAWINGS ARE FOR CONCEPTUAL AND ILLUSTRATIVE PURPOSES ONLY. ALL DIMENSIONS, EASEMENTS, LEVELS AND SPECIFICATIONS ARE APPROXIMATE AND SUBJECT TO MODIFICATION, SUBSTITUTION, OR CHANGE WITHOUT PRIOR NOTICE.

NO RELIANCE SHOULD BE PLACED ON THESE PLANS FOR FINAL DECISIONS REGARDING PURCHASING, DESIGN, OR CONSTRUCTION. HOLTZE LAND COMPANY PTY LTD DISCLAIMS ALL LIABILITY FOR ANY ERRORS, OMISSIONS, OR INACCURACIES CONTAINED HEREIN AND ACCEPTS NO LIABILITY FOR LOSS SUFFERED BY ANY PERSON WHO RELIES ON THIS PLAN.

